

Technical Features

	Thermo 230	Thermo 300	Thermo 350
EC approval mark	e1* 2001/56* 0007* _	e1* 2001/56* 0008* _	e1* 2001/56* 0009* _
Heat output	23.0 kW	30.0 kW	35.0 kW
Fuel, Fuel consumption	Diesel, fuel oil EL 2.5 l/h	Diesel, fuel oil EL 3.3 l/h	Diesel, fuel oil EL 3.7 l/h
Rated voltage	24 V	24 V	24 V
Rated power consumption	65 W	110 W	140 W
Flow rate circulating pump (against 0.15 / 0.4 bar)	5200 l/h / 6000 l/h	5200 l/h / 6000 l/h	5200 l/h / 6000 l/h
Dimensions of heater (l x w x h)	610 x 246 x 220 mm	610 x 246 x 220 mm	610 x 246 x 220 mm
Weight incl. control unit	19 kg	19 kg	19 kg

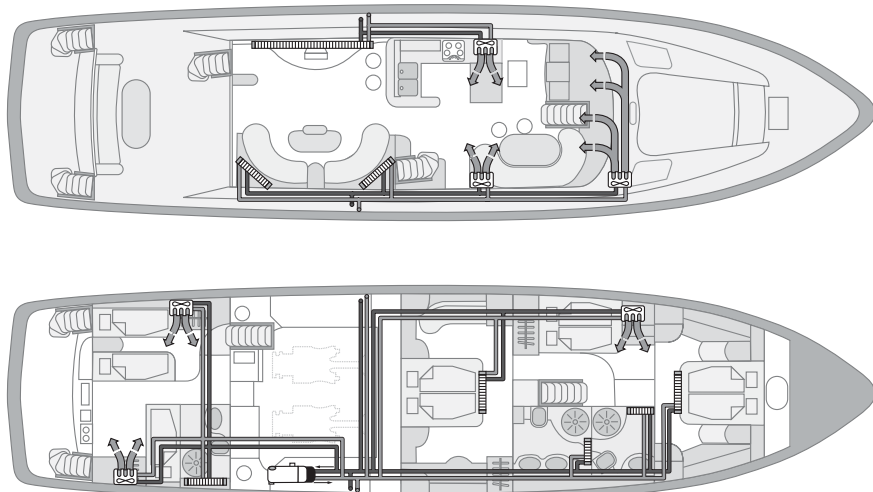

From the Thermo 230 heater in the engine room five separate heating circuits branch off. This allows a precise water flow regulation for each segment of the boat. A combination of convectors and fan blowers is used. For the windscreen a separate fan blower ensures to quickly demist and defrost.



Thermo 230 / 300 / 350 – for high heating power demands

The device is suitable for very large boats. The heater has the power to keep every part of your boat warm and challenges even extreme weather conditions. In case one heater is not sufficient (e.g. very large boats) two heaters can be combined.

Expert recommendation: Thermo 230 water station

The powerful and proven Thermo 230 water station is particularly well suited for heating up large boats and yachts. It is warm and cosy on board with sufficient hot water for comfortable relaxation.